

HF (13.56 MHz)
BIS M-122-01/A
 Order Code: BIS0048

BALLUFF

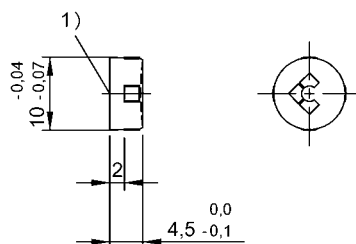

1) Sensing surface



Basic features

Antenna type	round
Approval/Conformity	CE WEEE EAC
EN 55022	Size 1, Cl. B
Principle of operation	Data carrier

Electrical data

Data retention time/years	≥ 10
Memory organization	47 × 16 bytes
Programming cycles	≥ 100.000
Programming time	for 16 bytes: 0.040s
Read cycles	Unlimited
Read time	User ID for 4 bytes: 0.02s for 16 bytes: 0.02 s

Environmental conditions

Ambient temperature	-25...70 °C
Continuous shock load	yes
EN 60068-2-27, Shock	yes
EN 60068-2-32 Free fall	yes
EN 60068-2-6, Vibration	yes
IP rating	IP67
Storage temperature	-25...85 °C

Functional Characteristics

Memory type	EEPROM
Supported data carrier types	DIN ISO 14443
UID serial number, read-only	4 Byte
User data, read/write	752 Byte

Functional safety

MTTF (40 °C)	1248 a
--------------	--------

Material

Housing material	PA 12, PU potted
------------------	------------------

Mechanical data

Application weight	1.50 g
Dimension	Ø 10 x 4.5 mm
Installation	metal-free (clear zone)

HF (13.56 MHz)
BIS M-122-01/A
Order Code: BIS0048

BALLUFF

Remarks

Time specification includes data check.

For installation requirements see corresponding read/write head.

Only when used together with the appropriate read/write head.

Values are under rated conditions unless otherwise specified.

Impact loading not permitted.

For more information about MTTF and B10d see MTTF / B10d Certificate

Indication of the MTTF- / B10d value does not represent a binding composition and/or life expectancy assurance; these are simply experiential values with no warranty implications. These declared values also do not extend the expiration period for defect claims or affect it in any way.