

HF (13.56 MHz)  
**BIS M-115-03/A-SA2**  
**Order Code: BIS00RZ**

**BALLUFF**

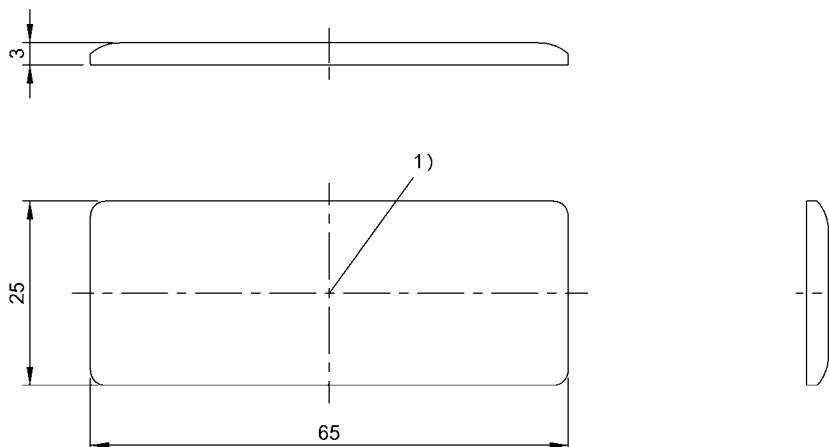

1) Sensing surface



### Basic features

<b>Antenna type</b>	Rectangular
<b>Approval/Conformity</b>	CE WEEE EAC
<b>EN 55011</b>	Size 1, Cl. A
<b>EN 55022</b>	Size 1, Cl. B
<b>Principle of operation</b>	Data carrier

### Electrical data

<b>Data retention time/years</b>	≥ 10
<b>Memory organization</b>	28 × 4 bytes
<b>Programming cycles</b>	up to 50 °C: 100,000
<b>Programming time</b>	for 16 bytes: 0.1s
<b>Read cycles</b>	Unlimited
<b>Read time</b>	User ID for 8 bytes: 0.02 s for 16 bytes: 0.03 s

### Environmental conditions

<b>Ambient temperature</b>	-25...50 °C
<b>Continuous shock load</b>	yes
<b>EN 60068-2-27, Shock</b>	yes
<b>EN 60068-2-32 Free fall</b>	yes
<b>EN 60068-2-6, Vibration</b>	yes
<b>IP rating</b>	IP65
<b>Storage temperature</b>	-30...60 °C

### Functional Characteristics

<b>Memory type</b>	EEPROM
<b>Supported data carrier types</b>	DIN ISO 15693
<b>UID serial number, read-only</b>	8 Byte
<b>User data, read/write</b>	112 Byte

### Material

<b>Housing material</b>	Epoxy-resin/fiberglass PVC
-------------------------	-------------------------------

### Mechanical data

<b>Application weight</b>	7.00 g
<b>Dimension</b>	25 x 3 x 65 mm

### Remarks

For installation requirements see corresponding read/write head.  
 Time specification includes data check.  
 Torsional, bending and impact loading is not permitted.

HF (13.56 MHz)

**BIS M-115-03/A-SA2**

**Order Code: BIS00RZ**

**BALLUFF**

Installation type on flat steel

Values are under rated conditions unless otherwise specified.

Only when used together with the appropriate read/write head.