

Machine Vision
 BVS CA-C1456Z00-35-000
 Ordercode: BVS002U

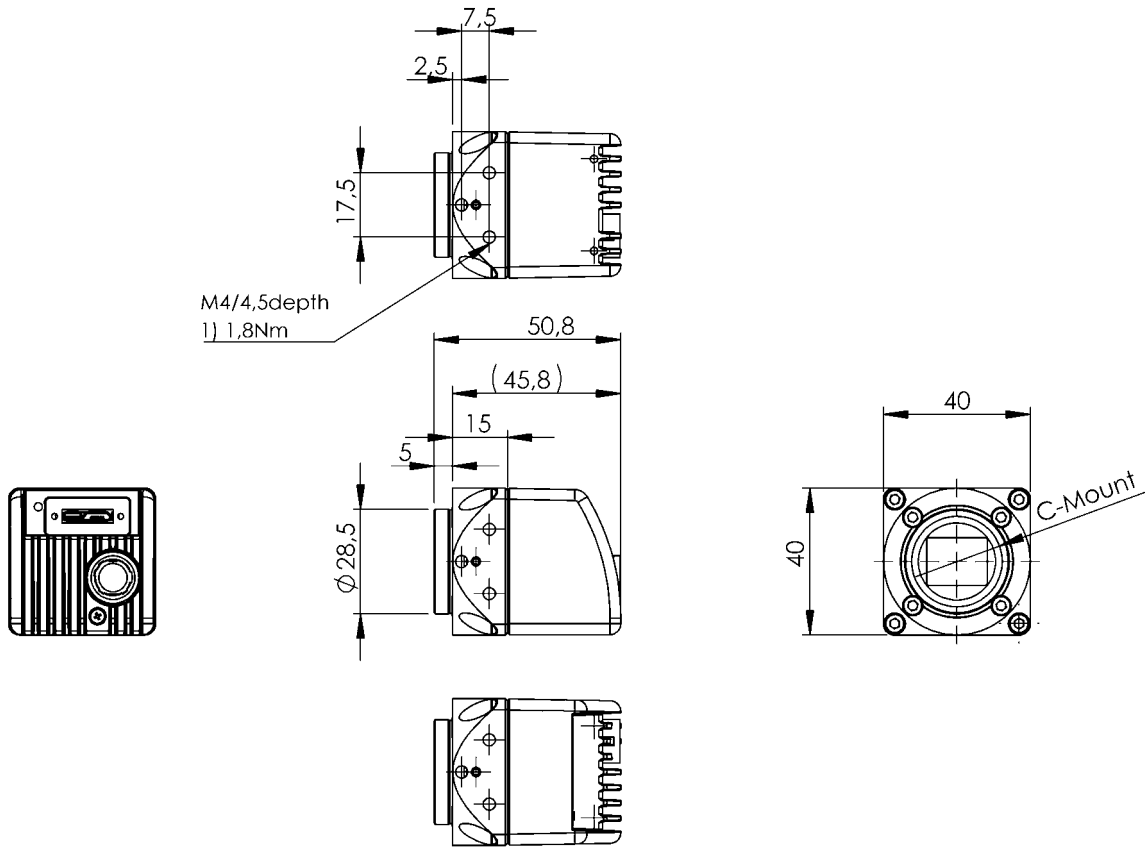

1) Tightening torque



Electrical connection

Polarity reversal protected	yes
Short-circuit protection	no

Electrical data

Data storage	256 Mbytes
No-load current I _o max., receiver at U _e	300 mA
Operating voltage U _b	11...25 VDC
Output current max.	500 mA
Ripple max. (% of U _e)	5 %

Environmental conditions

Ambient temperature	0...45 °C
Protection degree	IP40
Storage temperature	-20...60 °C

Functional Characteristics

Detection rate typ.	max. 226.1 fps
---------------------	----------------

Functional safety

MTTF (40 °C)	11.7 a
--------------	--------

General data

Approval/Conformity	CE FCC RoHS EMVA 1288 EAC
Principle of operation	Industrial camera

Material

Housing material	Aluminum
Housing material, surface protection	Painted

Mechanical data

Dimension	40 x 37.7 x 40 mm
Lens mount	C-Mount
Weight	157 g

Machine Vision
BVS CA-C1456Z00-35-000
 Ordercode: BVS002U

Optical data

Image formats	Mono8 Mono10 Mono12 Mono12p Mono14 Mono16
Image resolution	1456x1088 pixels
Pixel size	3.45 x 3.45 µm
Sensor chip	SONY IMX273
Sensor type Vision	CMOS 1/2,9" color global shutter

Output/Interface

Digital inputs	2x PNP opto-isolated
----------------	----------------------

Interface	USB 2.0 / 3.0
Switching output	4x PNP normally open (NO)

Remarks

Not included in the scope of delivery:
 Lens, filter, light, connection cable
 see www.balluff.de

For more information about MTTF and B10d see MTTF / B10d Certificate

Indication of the MTTF- / B10d value does not represent a binding composition and/or life expectancy assurance; these are simply experiential values with no warranty implications. These declared values also do not extend the expiration period for defect claims or affect it in any way.

Connector view

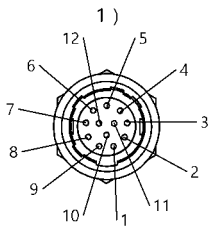

- 1)
- 2) I/O
- 1 — PWR_IN-/GND
 - 2 — PWR_IN+1
 - 3 — Opto DigOut3
 - 4 — Opto DigIn0
 - 5 — Opto DigOut2
 - 6 — Opto DigOut0
 - 7 — Opto GND
 - 8 — RS232 RX
 - 9 — RS232 TX
 - 10 — OUT_V+
 - 11 — Opto DigIn1
 - 12 — Opto DigOut1