

Machine Vision  
 BVS CA-C2064Z00-35-000  
 Ordercode: BVS002Y

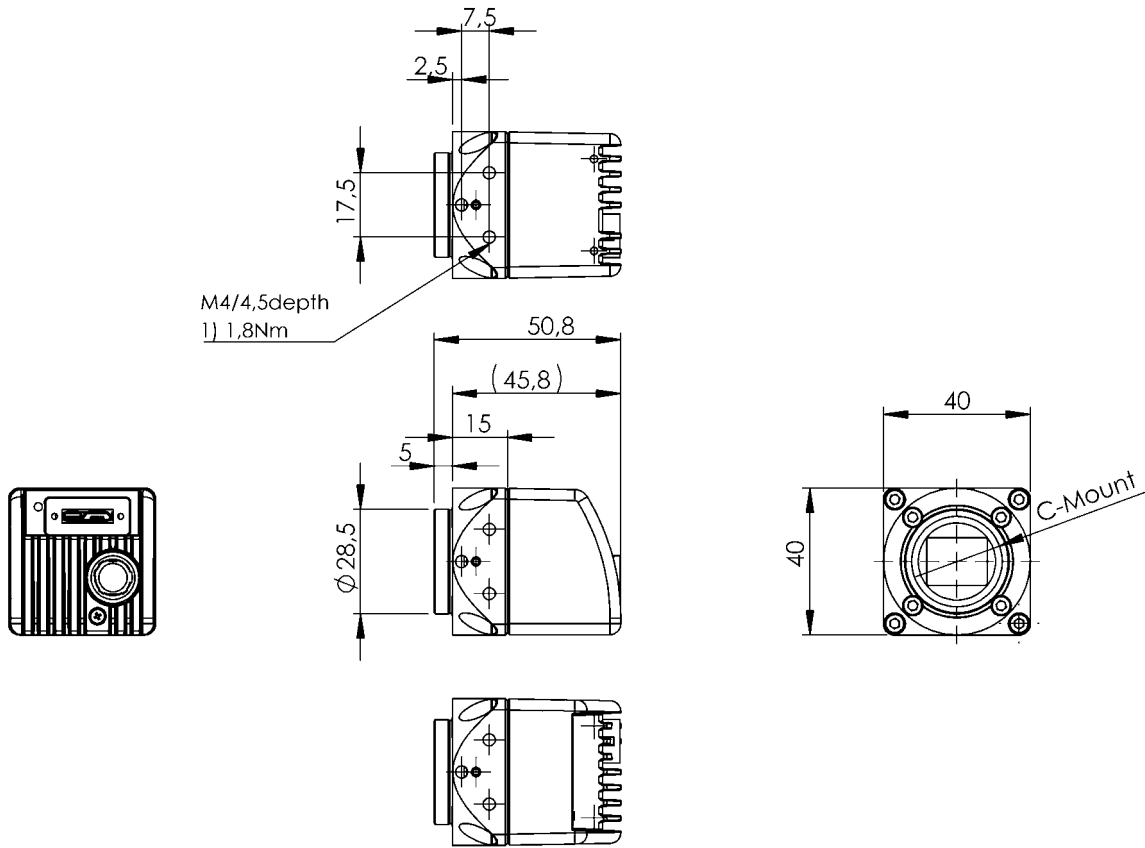

1) Tightening torque



### Electrical connection

Polarity reversal protected	yes
Short-circuit protection	no

### Electrical data

Data storage	256 Mbytes
No-load current I <sub>o</sub> max., receiver at U <sub>e</sub>	300 mA
Operating voltage U <sub>b</sub>	11...25 VDC
Output current max.	500 mA
Ripple max. (% of U <sub>e</sub> )	5 %

### Environmental conditions

Ambient temperature	0...45 °C
Protection degree	IP40
Storage temperature	-20...60 °C

### Functional Characteristics

Detection rate typ.	max. 55 fps
---------------------	-------------

### Functional safety

MTTF (40 °C)	11.7 a
--------------	--------

### General data

Approval/Conformity	CE FCC RoHS EMVA 1288 EAC
Principle of operation	Industrial camera

### Material

Housing material	Aluminum
Housing material, surface protection	Painted

### Mechanical data

Dimension	40 x 37.7 x 40 mm
Lens mount	C-Mount
Weight	157 g

### Optical data

Image formats	Mono8 Mono10 Mono12 Mono12p Mono14 Mono16
Image resolution	2064 x 1544 pixels
Pixel size	3.45 x 3.45 µm
Sensor chip	SONY IMX265
Sensor type Vision	CMOS 1/1,8" color global shutter

### Output/Interface

Digital inputs	2x PNP opto-isolated
----------------	----------------------

Interface	USB 2.0 / 3.0
Switching output	4x PNP normally open (NO)

### Remarks

Not included in the scope of delivery:  
 Lens, filter, light, connection cable  
 see [www.balluff.de](http://www.balluff.de)

For more information about MTTF and B10d see MTTF / B10d Certificate

Indication of the MTTF- / B10d value does not represent a binding composition and/or life expectancy assurance; these are simply experiential values with no warranty implications. These declared values also do not extend the expiration period for defect claims or affect it in any way.

### Connector view

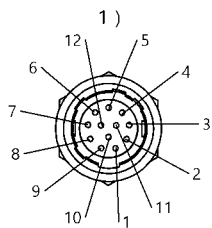

- 1 )
- 2 ) I/O
- 1 PWR\_IN-/GND
  - 2 PWR\_IN+1
  - 3 Opto DigOut3
  - 4 Opto DigIn0
  - 5 Opto DigOut2
  - 6 Opto DigOut0
  - 7 Opto GND
  - 8 RS232 RX
  - 9 RS232 TX
  - 10 OUT\_V+
  - 11 Opto DigIn1
  - 12 Opto DigOut1