

Machine Vision
 BVS CA-M2464Z00-35-000
 Ordercode: BVS002Z

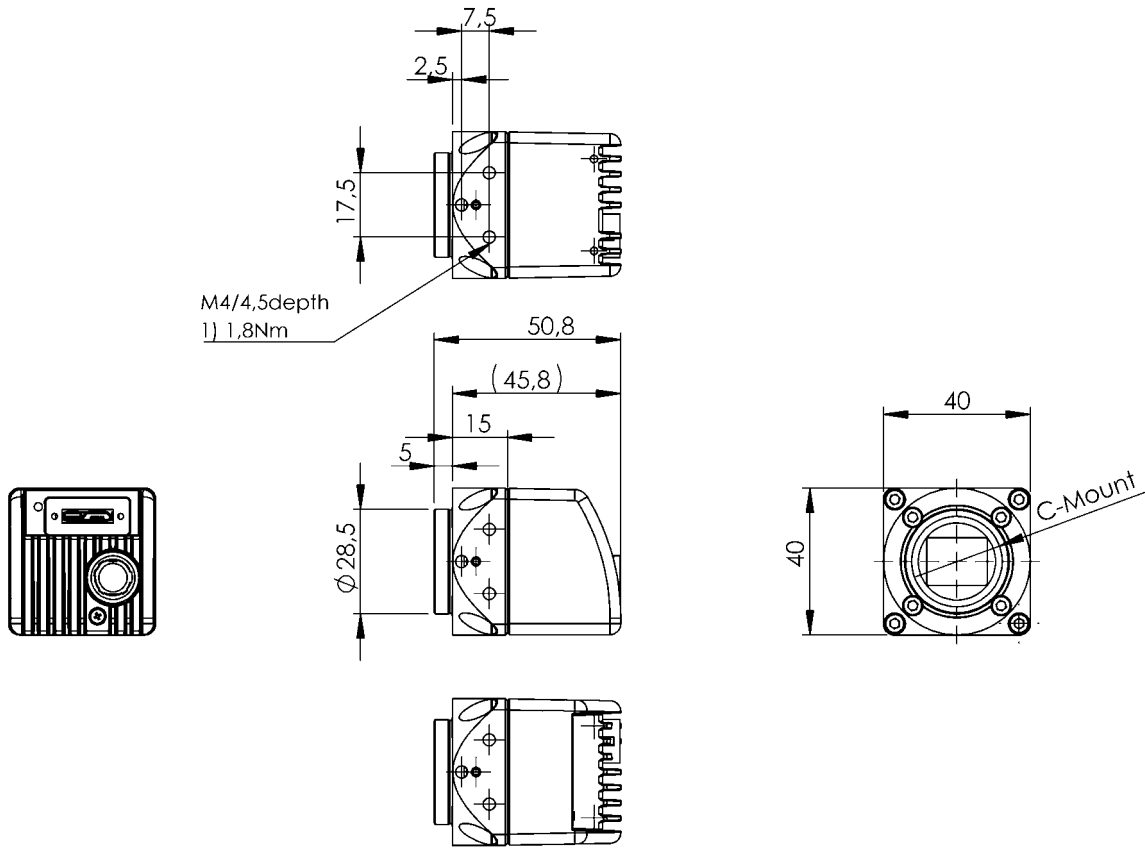

1) Tightening torque



Electrical connection

Polarity reversal protected	yes
Short-circuit protection	no

Electrical data

Data storage	256 Mbytes
No-load current I _o max., receiver at U _e	300 mA
Operating voltage U _b	11...25 VDC
Output current max.	500 mA
Ripple max. (% of U _e)	5 %

Environmental conditions

Ambient temperature	0...45 °C
Protection degree	IP40
Storage temperature	-20...60 °C

Functional Characteristics

Detection rate typ.	max. 35.6 fps
---------------------	---------------

Functional safety

MTTF (40 °C)	11.7 a
--------------	--------

General data

Approval/Conformity	CE FCC RoHS EMVA 1288 EAC
Principle of operation	Industrial camera

Material

Housing material	Aluminum
Housing material, surface protection	Painted

Mechanical data

Dimension	40 x 37.7 x 40 mm
Lens mount	C-Mount
Weight	157 g

Machine Vision
BVS CA-M2464Z00-35-000
Ordercode: BVS002Z

Optical data

Image formats	Mono8 Mono10 Mono12 Mono12p Mono14 Mono16
Image resolution	2464 x 2056 pixels
Pixel size	3.45 x 3.45 µm
Sensor chip	SONY IMX265
Sensor type Vision	CMOS 2/3" monochrome global shutter

Output/Interface

Digital inputs	2x PNP opto-isolated
----------------	----------------------

Interface	USB 2.0 / 3.0
Switching output	4x PNP normally open (NO)

Remarks

Not included in the scope of delivery:
Lens, filter, light, connection cable
see www.balluff.de

For more information about MTTF and B10d see MTTF / B10d Certificate

Indication of the MTTF- / B10d value does not represent a binding composition and/or life expectancy assurance; these are simply experiential values with no warranty implications. These declared values also do not extend the expiration period for defect claims or affect it in any way.

Connector view

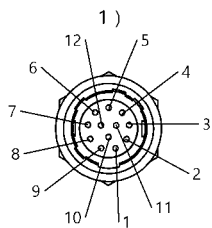

- 1)
- 2) I/O
- 1 PWR_IN-/GND
 - 2 PWR_IN+1
 - 3 Opto DigOut3
 - 4 Opto DigIn0
 - 5 Opto DigOut2
 - 6 Opto DigOut0
 - 7 Opto GND
 - 8 RS232 RX
 - 9 RS232 TX
 - 10 OUT_V+
 - 11 Opto DigIn1
 - 12 Opto DigOut1